

AMENDED PLANS

Abacus LEADERS IN LIGHTING

08 OCT 2008

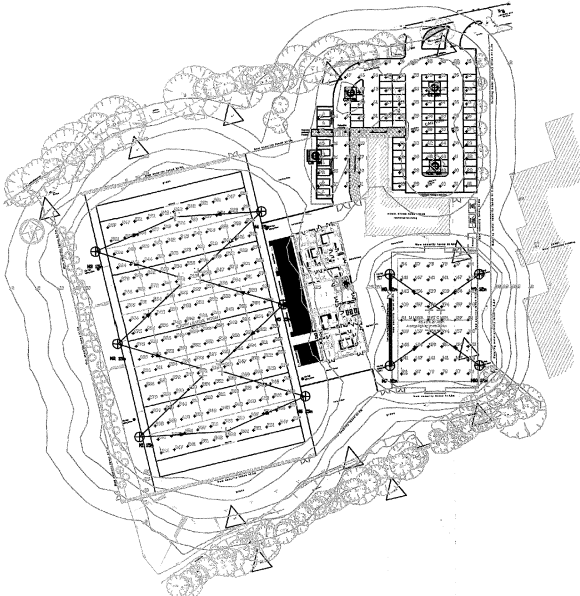

**FLOODLIGHTING EQUIPMENT:**

**RUGBY PITCH:**  
 5 x 15m MASTS (M1-M5)  
 EACH CARRYING THE FOLLOWING FLOODLIGHTS:  
 M1,M2,M4,M5.....1 x AL8767/2KW/WH-TS2000WL  
 M2,M5.....1 x AL2786/2KW/WH-TS2000WL  
 M2,M5.....2 x AL0765/2KW/WH-TS2000WL

**MUGA PITCH:**  
 4 x 12m MASTS (M7-M10)  
 EACH CARRYING THE FOLLOWING FLOODLIGHTS:  
 M5-M8.....1 x AL5219/1000W/WHI + ALS299 COWL

**CARPARK:**  
 4 x 8m COX LAMNS(C1-C4)  
 EACH CARRYING THE FOLLOWING LANTERNS:  
 C1,C2.....1 x AL4001400SON-T  
 C3.....1 x AL5002400SON-T

**LAMPS:**  
 2KW MH-TS2000WL/K124K (240 000 INITIAL Lm)  
 1KW/WHI (80 000 INITIAL Lm)  
 400W SON-T/TP (50 000 INITIAL Lm)

**ILLUMINANCE LEVELS: (INDIVIDUALLY SWITCHED)**

**RUGBY PITCH:**  
 INITIAL (100 Hrs)  
 E.Lave = 500 LUX  
 MAINTAINED (4000 Hrs)  
 E.m.ave = 231 LUX

**UNIFORMITY**  
 Emin/Eave = 0.69

**MUGA PITCH:**  
 INITIAL (100 Hrs)  
 E.Lave = 132 LUX  
 MAINTAINED (4000 Hrs)  
 E.m.ave = 102 LUX

**UNIFORMITY**  
 Emin/Eave = 0.60

**CARPARK:**  
 INITIAL (100 Hrs)  
 E.Lave = 30 LUX  
 MAINTAINED (4000 Hrs)  
 E.m.ave = 20 LUX

**UNIFORMITY**  
 Emin/Eave = 0.32

**GRID VALUES IN LUX**  
 GRID INTERVAL = 5m  
 CONTOUR VALUES IN LUX  
 CONTOURS 2.5,10,25,50 LUX

**MAINTENANCE FACTOR = 0.77**

**BASED UPON:**  
 DIRT DEPRECIATION FACTOR = 7%  
 CLEANING INTERVAL = 12 MONTHS  
 LOCATION = MEDIUM POLLUTION  
 LAMP LUMEN DEPRECIATION = 17%  
 BLUE LAMP REPLACEMENT AT 4000 Hrs  
 SPOT LAMP REPLACEMENT UNDERTAKEN



ABACUS LIGHTING LTD.  
 Sutton-in-Ashfield, Nottinghamshire  
 NG17 5FT England  
 Tel: (+44) 01623 511111  
 Fax: (+44) 01623 502133  
 Email: light@abacუსlighting.com  
 Home page: www.lighting4sport.com

Lighting Project: EXTERNAL FLOODLIGHTING	
Title: HEMEL HEMPSTEAD RLFC	Revision(s) From Previous Design:
Design Ref: UKS38534	
Design By: ROB SCOTT	
Date: 03/09/2008	Scale: 1:750 @ A2

All dimensions shown are the result of computer calculations. Unless stated, all dimensions are in millimetres to the nearest millimetre. The client shall be responsible for checking the accuracy of the data and any other information provided for the purposes of this drawing.